

Dimension: (UNIT:mm)

A	6.0 ± 0.15
B	3.90 <sup>+0</sup> <sub>-0.20</sub>
C	2.8 ± 0.05
D	2.1 <sup>+0</sup> <sub>-0.2</sub>
E	4.4 ± 0.15
F	1.80 <sup>+0</sup> <sub>-0.2</sub>
G	0.9±0.1
H	

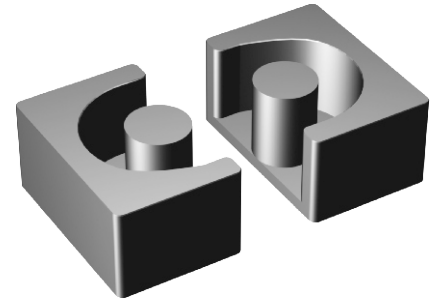
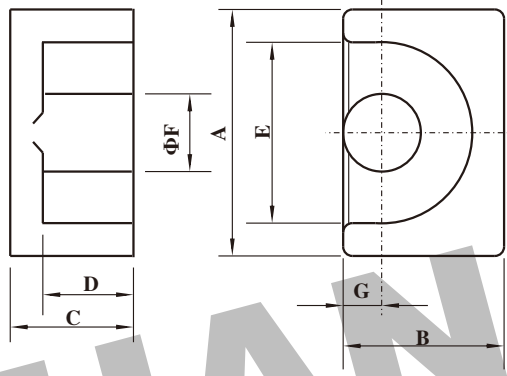

**Test conditions**

AL: F=1.0KHz U=0.3V N=10Ts

**Effective parameter**

C1(mm) <sup>-1</sup>	Ae(mm <sup>2</sup> )	Le(mm)	Ve(mm <sup>3</sup> )	Weight(g)
3.20	3.0	9.7	28.7	≈0.5

Core sets for general purpose transformers and Power applications.

Core sets of high permeability grades.

Clamping force for AI measurements,20+/-10N.

Clamping force for AI measurements,10+/-5N

Grade	AL (nH)	μe	AIR GAP μm	Type number
P4	16 ± 3%	≈ 41	≈ 320	EP 5-P4
	25 ± 3%	≈ 64	≈ 170	EP 5-P4
	40 ± 5%	≈ 102	≈ 90	EP 5-P4
	63 ± 8%	≈ 160	≈ 50	EP 5-P4
	400 ± 25%	≈ 1020	≈ 0	EP 5-P4
HQ2KA	380 ± 25%	≈ 970	≈ 0	EP 5-HQ2KA
P5	16 ± 3%	≈ 41	≈ 320	EP 5-P5
	25 ± 3%	≈ 64	≈ 170	EP 5-P5
	40 ± 5%	≈ 102	≈ 90	EP 5-P5
	63 ± 8%	≈ 160	≈ 50	EP 5-P5
	320 ± 25%	≈ 815	≈ 0	EP 5-P5

Grade	AL (nH)	μe	AIR GAP μm	Type number
H10K	16 ± 3%	≈ 41	≈ 320	EP 5-H10K
	25 ± 3%	≈ 64	≈ 170	EP 5-H10K
	40 ± 5%	≈ 102	≈ 90	EP 5-H10K
	63 ± 8%	≈ 160	≈ 50	EP 5-H10K
	2000+40/-30%	≈ 5100	≈ 0	EP 5-H10K
H12K	2200+40/-30%	≈ 5600	≈ 0	EP 5-H12K

**Properties of core sets under power conditions**

Grade	B (mT)at	Core loss (w) at			
	H=250 A/m F=10KHz T=100℃	F=100 KHz B̄=100mT T=100℃	f=100 KHz B̄=200mT T=100℃	F=500 KHz B̄=50 mT T=100℃	F=500 KHz B̄=100mT T=100℃
P4	≥ 320	≤ 0.002	≤ 0.014	-	-
HQ2KA	≥ 340	-	≤ 0.011	≤ 0.009	-
P5	≥ 300	-	-	≤ 0.003	≤ 0.025

**Note:**

- 1: Document is the property of FUAN Inc & is not allow to be duplicated without authorization
- 2: RoHS compliant.